

PERMWALL

HIGH PERFORMANCE FLUSH METAL WALL PANEL SYSTEMS

IMETCO's **PermWall** 1.0 and 1.5 flush wall panel systems are engineered for strength and longevity, and designed for the beauty of smooth consistency.

Concealed fasteners secure virtually invisible vertical seams that are tested and warranted to the high-performance and quality standards for which IMETCO's products are renowned.

PermWall 1.0 & 1.5 Test Results

ASTM E 283 Air Infiltration Test *scfm (Square Cubic Feet per Minute)*

Air leakage rate per Foot of Seam

- 1.57 psf/in = 0.262 scfm
- 6.24 psf/in = 0.449 scfm
- 12.0 psf/in = 0.494 scfm
- 15.0 psf/in = 0.514 scfm
- 20.0 psf/in = 0.594 scfm

Air leakage rate per Square Foot

- 1.57 psf/in = 0.033 scfm
- 6.24 psf/in = 0.056 scfm
- 12.0 psf/in = 0.062 scfm
- 15.0 psf/in = 0.064 scfm
- 20.0 psf/in = 0.074 scfm

ASTM E 331 Water Penetration Test

Vacuum Test Pressure - NO LEAKAGE

- 2.86 psf/in 12.0 psf/in
- 6.24 psf/in 20.0 psf/in

ASTM E 330 Test Method for Structural Performance of Wall Panels

The E330 Uniform Static Load test for 1 1/2" panel profile has provided an allowable of 42 lb/sq ft. for 3'-0" spans and 52 lb/sq.ft for 1'-0" spans.

PermWall systems are available in a wide range of colors and gauges, and are custom-formed by IMETCO's talented metal craftsmen to suit the unique design and performance requirements of each and every project.

IMETCO's engineers assist you at every stage of your project with design support, specialty engineering, code compliance support, and custom shop drawing packages and installation guidelines.

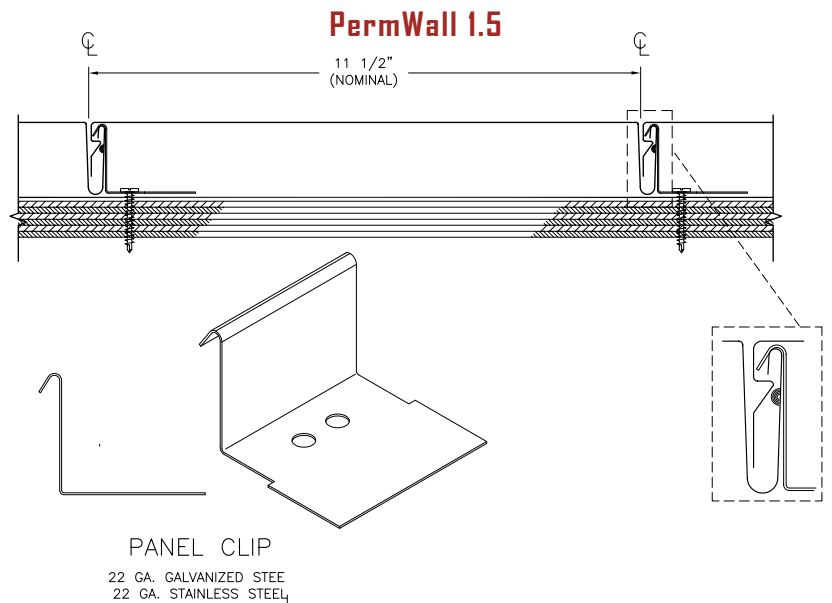
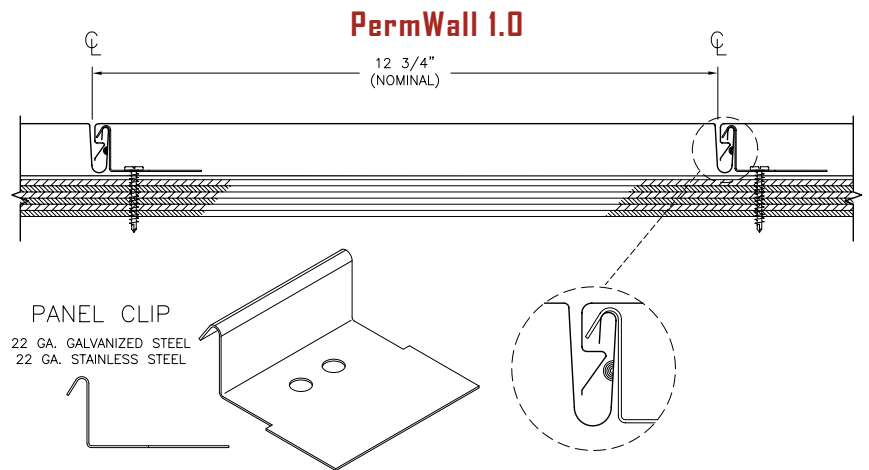

Specifications (approx.)

Thickness:	60 mil
Roll Size (212 ft.):	64.5 x 3.28 ft
Roll Size (meters):	19.7 x 1 m
Coverage:	200 ft ² (18.7m ²)
Roll Weight:	80 lbs. (36.4 kg)
Weight/100 ft ² :	40 lbs. (17.9 kg)
Top Surface:	Polyester
Bottom:	100% SBR-Mod. Bitumen
Min. Install Temp.:	50° F
Tensile Strength ¹ - Longitudinal (MD):	83 lbf/inch
Tensile Strength ¹ - Transverse (XMD):	59 lbf/inch
Elongation ¹ - Longitudinal (MD):	47%
Elongation ¹ - Transverse (XMD):	41%
Tear Strength ² - Longitudinal (MD):	38 lbf
Tear Strength ² - Transverse (XMD):	35 lbf

¹ ASTM D5147; at 25° C.

² Method used: 2" x 12" sample cut 6" along center; pulled at 5" per minute with sample held at 90° angle.

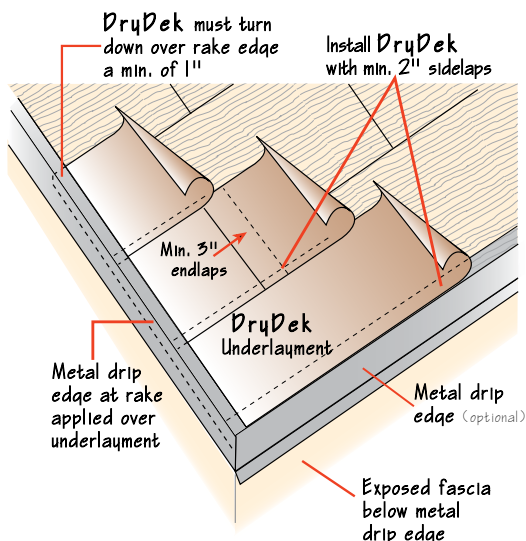

For more information about DryDek and other solutions from IMETCO, call us at 800.646.3826 or visit www.imetco.com.

This brochure contains the most up-to-date information on DryDek. However, changes and modifications to this publication and to DryDek may be made without notice. As with all roofing installations, it is the responsibility of the contractor or installer to provide adequate fall protection for all roofing and construction personnel. Information contained herein is given in good faith and concerns data gathered during normal production of material. IMETCO reserves the right to modify its products at any time, and without prior notice.

IMETCO
INNOVATIVE METALS COMPANY, INC.

A recognized leader in the metal roofing industry, IMETCO™ offers a full range of standing seam metal roofing, metal wall panels, fascia and coping systems, and a variety of accessories.

For more than a decade, we at IMETCO have enjoyed our reputation as a manufacturer committed to providing only the highest quality of products. Our staff comprises expertise in metal roofing, metal design, engineering, testing and code compliance, manufacturing, and more. Above all, our staff excels in providing unparalleled customer service.

Our special capabilities, such as curving, tapering, field forming, and oversized panels allow you to realize your creativity through the beauty and strength of our metal systems. Our product lines include:

- Architectural and structural standing seam roofing systems
- Symmetrical and asymmetrical profiles
- Wall panels
- Fascia and coping systems
- Accessories
- And more!

All systems are available in a variety of materials and specialty finishes. Our in-house engineering team provides project support and produces custom shop drawings for each and every job. Our project managers work as an extension of your organization to streamline the procurement and delivery of materials. Our value-added production services help us accommodate even the most aggressive installation schedules.

With a zeal for excellence, the IMETCO team is dedicated to offering a level of service and support that exceeds expectations.

Your satisfaction is our only measure of success!

IMETCO

High-Performance Metal Systems & Accessories

www.imetco.com • 2070 Steel Drive, Tucker, GA 30084 • 800.646.3826 • learn@imetco.com